

BALL LOCK PUNCHES

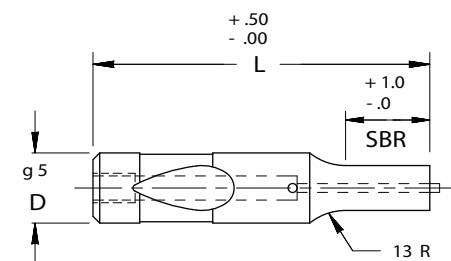

HEAVY DUTY/EJECTOR

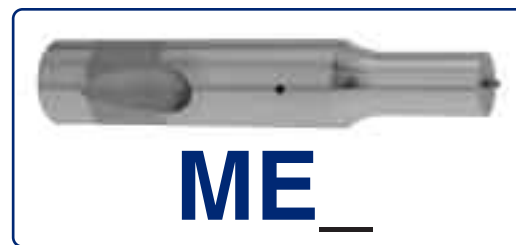
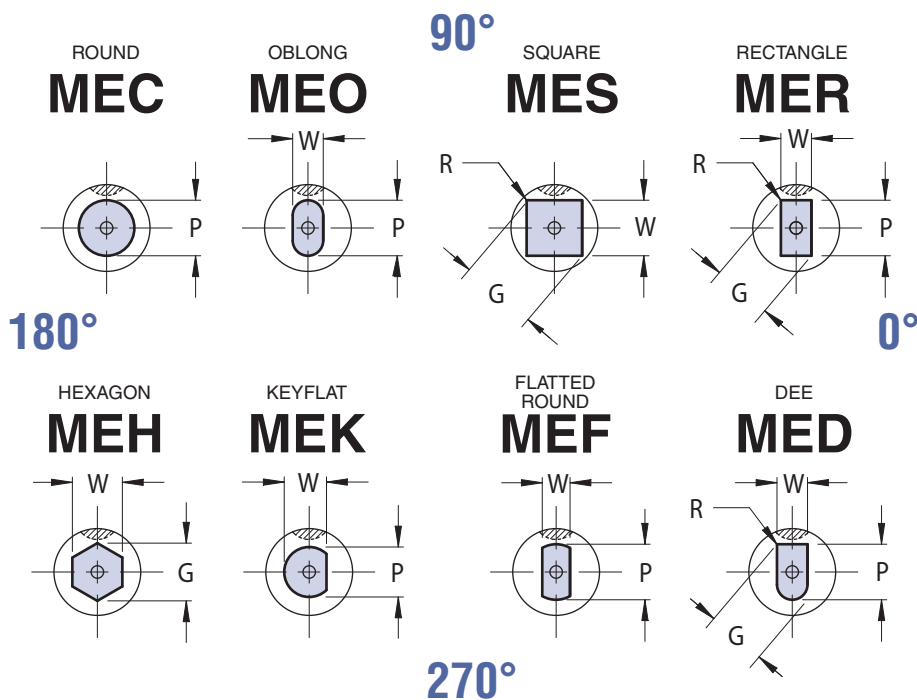

FOR STANDARD ALTERATIONS SEE PAGES 49-54.

VIEWS ARE SHOWN LOOKING THROUGH THE SHANK BUT DRAWN WITH SOLID LINES FOR CLARITY.

CATALOG TYPE	SHANK DIA D	ROUND	SHAPE		OVERALL LENGTH "L"					
		RANGE P	MIN W	MAX G/P	71	80	90	100	110	125
ME_10	10	2.50 - 9.98	2.50	10.00	X	X	X	X		
ME_13	13	5.00 - 12.98	4.50	13.00	X	X	X	X	X	X
ME_16	16	8.00 - 15.98	6.00	16.00	X	X	X	X	X	X
ME_20	20	12.00 - 19.98	8.00	20.00	X	X	X	X	X	X
ME_25	25	16.00 - 24.98	10.00	25.00		X	X	X	X	X
ME_32	32	24.00 - 31.98	12.00	32.00		X	X	X	X	X
ME_40	40	30.00 - 39.98	14.00	40.00		X	X	X	X	X

Material

Steel: M2, RC 60-63

Standard Point Tolerance

Round P	+ .01 - .00	⊙ .01	P to D
Shape P, W	± .01	⊙ .02	P to D

When P = D Shank Tolerances Apply

CATALOG TYPE	SHANK D	SBR			EJECTOR SIZE
		NAPMA STD	ALTERNATES		
			B	C	
ME_10	10	19	10	—	MAE 4
ME_13	13	19	13	25	MAE 5
ME_16	16	19	13	25	MAE 5
ME_20	20	19	13	25	MAE 6
ME_25	25	19	13	25	MAE 6
ME_32	32	19	13	25	MAE 6
ME_40	40	25	19	30	MAE 6

L=71 SBR MAX=19

STANDARD BALL SEAT LOCATION IS AT 90° AS SHOWN. AVAILABLE AT 0°, 180°, 270°, FOR SAME PRICE.